

CE XD9000

SERIAL NO. 628504 AND UP

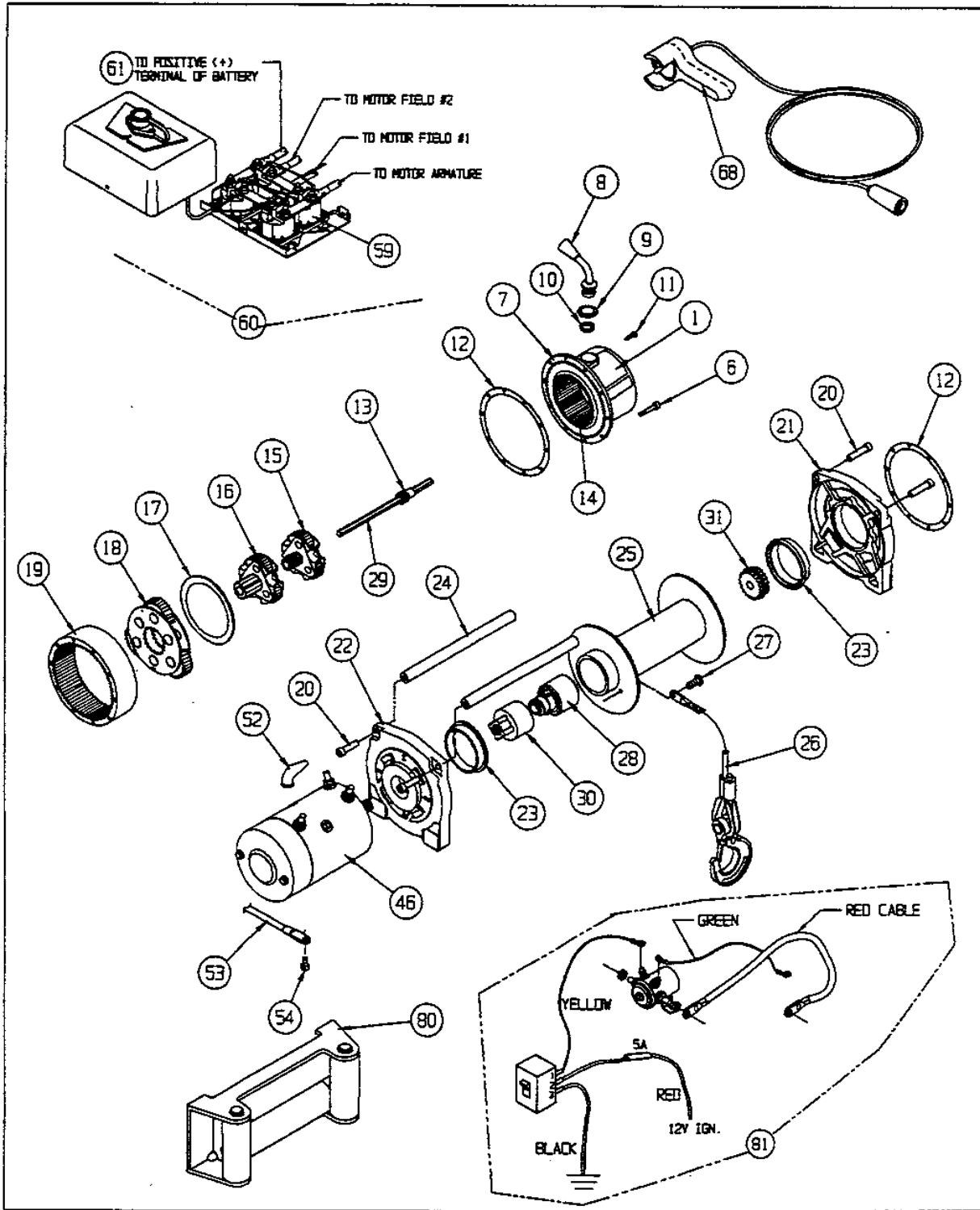

WARN CE XD9000 WINCH REPLACEMENT PARTS LIST			
(P/N 285002)			
SERIAL NO. 628504 AND UP			
ORDERING INFORMATION:			
When ordering please give Warn Model, Serial Number & Battery voltage.			
Parts may be obtained through your local dealer or distributor.			
ITEM	QTY	PART NO.	DESCRIPTION
1	1	38306	LABEL, KIT, CE XD9000
2	1		LABEL, CE
3	1		LABEL DRUM ROTATION
4	1		WARNING, HOT
5	1		LABEL, NAMEPLATE
6	10	13850	SOCKET HEAD CAPSCREW, 10-24 x 2 1/2
7	1	37131	END HOUSING, ASSEMBLY
8	1		CLUTCH LEVER
9	1		RETAINER, SEAL
10	1		SEAL, O-RING
11	1		CLUTCH LEVER DETENT SCREW
12	2	13848	GASKET
13	1	13874	SUN GEAR
14	1	13839	RING GEAR, SLIDING
15	1	34339	CARRIER ASSEMBLY, STAGE 1
16	1	34342	CARRIER ASSEMBLY, STAGE 2
17	1	13826	THRUST BEARING
18	1	28432	CARRIER ASSEMBLY, STAGE 3
19	1	25308	RING GEAR
20	4	60451	SOCKET HEAD CAPSCREW, 5/16-18 x 1-1/4, SELF TAPPING
21	1	25986	DRUM SUPPORT, GEAR TRAIN
22	1	25985	DRUM SUPPORT, MOTOR
23	2	13831	DRUM BUSHING
24	2	32408	TIE ROD
25	1	26107	DRUM ASSEMBLY
26	1	38314	WIRE ROPE ASSY, 5/16x100' W/THIMBLE
27	1	13699	BUTTON HEAD CAPSCREW
28	1	32455	BRAKE ASSEMBLY
29	1		HEX SHAFT, 10.1
30	1		MOTOR COUPLER
31	1		DRIVE SPLINED W/RETAINING RING
46	1	39972	MOTOR, 12 VDC, BIC

WARN CE XD9000 WINCH REPLACEMENT PARTS LIST			
ORDERING INFORMATION:			
When ordering please give Warn Model, Serial Number & Battery voltage.			
Parts may be obtained through your local dealer or distributor.			
ITEM	QTY	PART NO.	DESCRIPTION
52	3	2090	BOOT, ELECTRICAL TERMINAL
53	1	15901	CABLE ASSEMBLY, ELECTRICAL, 2 GA x 72" (BLACK)
54	1	26744	HEX HEAD CAPSCREW, M8 x 1.25 x 12MM
59	4	28396	SOLENOID, UPRIGHT TERMINAL
60	1	39968	WINCH CONTROL, 12 VDC
61	1	33295	CABLE ASSEMBLY, ELECTRIC, 2GA x 72" RED
68	1	38626	REMOTE CONTROL ASSY.
80	1	5742	ROLLER, FAIRLEAD
81	1	32959	POWER INTERRUPT KIT
P/N 36622 REV C0			